

Clips, Clamps & Fixing Elements

(Selected Products)

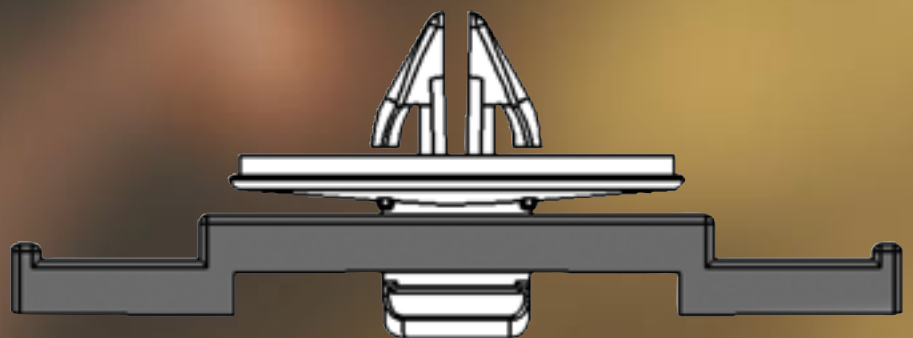

DELPHI

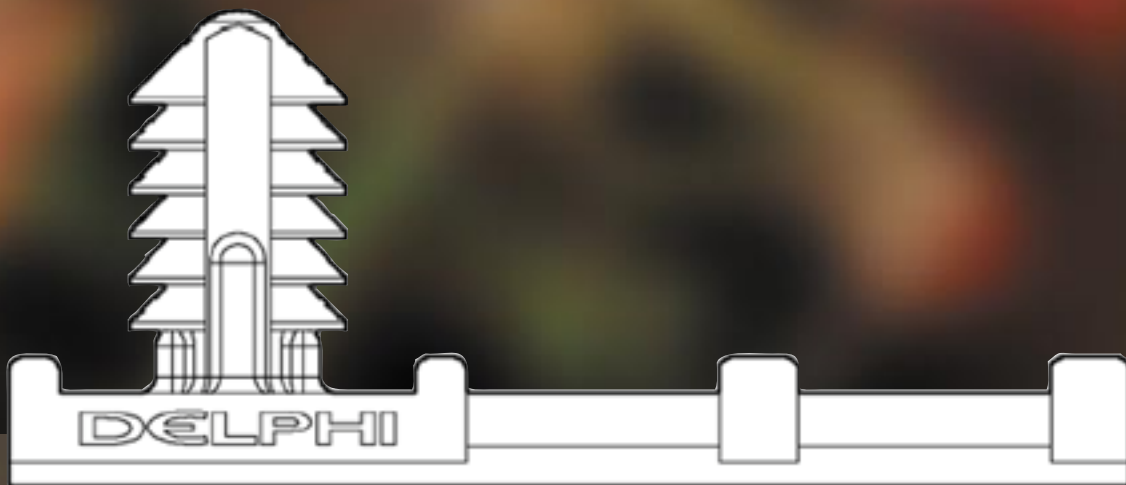

Summary

- Fir tree clips
- Rosebud clips
- Clip assemblies
- Wire / FPC holder & wire tie clips
- Conduit clips
- Conduit clamps and assemblies
- Rosebud connector fixing
- Fir tree & connector fixing



Fir tree clips

Description

- Polypropylene and nylon tape-on clips

Typical applications

- Harness clips taped on to wire bundles or wire ties wrapped around conduit or bundle

Delphi advantages

- A clip for many applications can be found

Fig	Part number	Hole diameter (nominal)	Sheet metal thickness (max.)	Material	Color
1	15428146	6.35	4.6	Polypropylene	gray
2	12045640	6.35	12.5	Polypropylene	gray
3	06288546	3.57	4.5	Polypropylene	natural
4	12160857	6.35	5.0	Polypropylene	gray
5	15305148	6.35	2.0	Nylon 66	black
6	12110185	6.63	3.8	Polypropylene	black
7	15473936	6.3	6.3	Nylon 66	dark gray
8	15475295	7.00	6.3	Nylon 66	dark gray
9	15449890	6.65	6.3	Nylon 66	black
10	00332364	6.35	6.0	Nylon 66	black
11	15497753	6.3	6.3	Nylon 66	gray

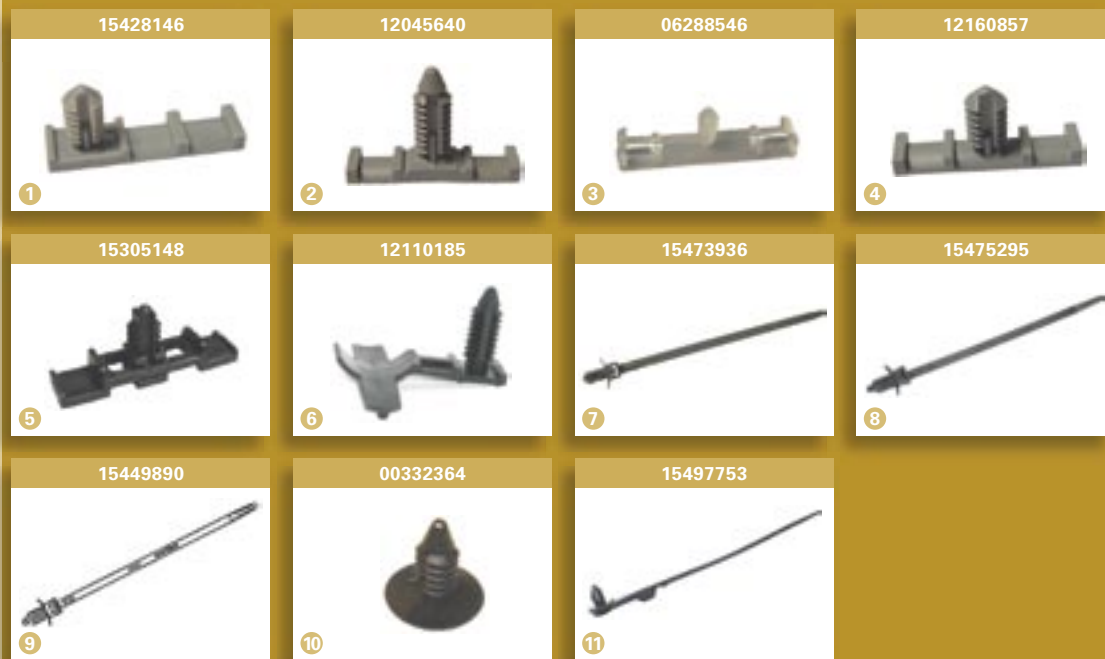

Rosebud clips

Description

- Polypropylene and nylon tape-on clips

Typical applications

- Harness clips taped on to wire bundles or wire ties wrapped around conduit or bundle

Delphi advantages

- A clip for many applications can be found

Fig	Part number	Hole diameter (nominal)	Sheet metal thickness (max.)	Material	Color
1	12010340	6.35	3.8	Polypropylene	gray
2	12089070	6.35	3.8	Polypropylene	black
3	08911496	7.34	6.4	Polypropylene	black
4	02984537	6.35	2.3	Nylon 66	natural
5	08900467	8.00	7.6	Nylon 66	black
6	02965782	6.35	2.3	Nylon 66	natural
7	08917032	6.35	3.8	Polypropylene	natural
8	15463883	6.35	1.2	Nylon 66	black
9	15369298	6.3	1.5	Nylon 66	black
10	08900116	6.35	3.3	Polypropylene	gray
11	12048408	6.35	3.8	Polypropylene	gray
12	02989918	6.35 Stud/Bolt size		Polypropylene	black
13	12147875	6.3	0.9 - 2.3	Nylon 66	black
14	10719961	6.35	0.9 - 2.3	Nylon 66	natural
15	15344856	6.35	0.9 - 2.3	Nylon 66	natural

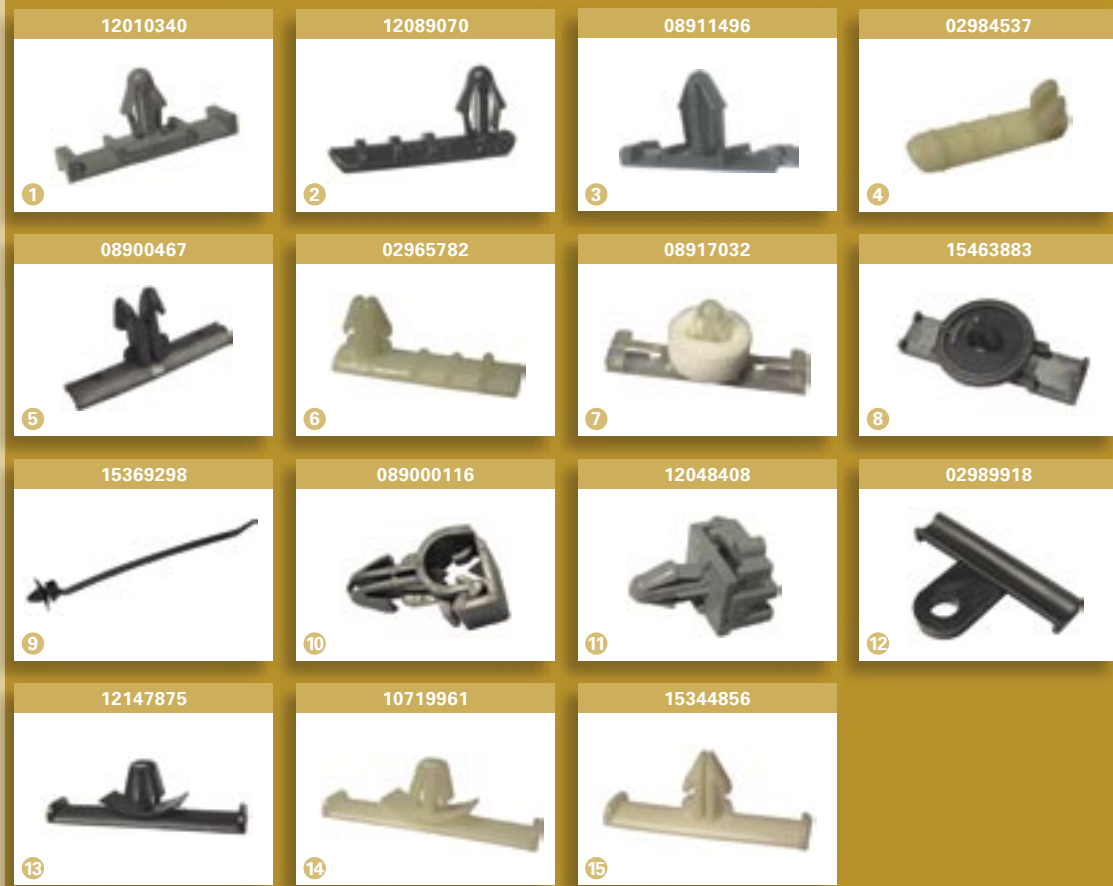

Clip assemblies

Description

- Polypropylene and nylon tape-on clips

Typical applications

- Harness clips taped on to wire bundles or wire ties wrapped around conduit or bundle

Delphi advantages

- A clip for many applications can be found

Fig	Part number	Sheet metal thickness (max.)	Material	Color
1	12020395	0.8 - 1.8	Nylon 66	medium gray
2	06288468	0.8 - 1.8	Nylon 66	natural
3	12020842	0.8 - 1.8	Nylon 66	medium gray

12020395



06288468



12020842



Wire / FPC holder & wire tie clips

Description

- Polypropylene and nylon tape-on clips

Typical applications

- Harness clips taped on to wire bundles or wire ties wrapped around conduit or bundle

Delphi advantages

- A clip for many applications can be found

Fig	Part number	Hole diameter (nominal)	Sheet metal thickness (max.)	Material	Color
1	08900933			Polypropylene	black
2	12040700			Polypropylene	black
3	02977672			Nylon 66	natural
4	15473936	6.3	6.3	Nylon 66	dark gray
5	15475295	7.0	6.3	Nylon 66	dark gray
6	15449890		6.3	Nylon 66	black
7	15465829			Nylon 66	dark gray
8	15369298	6.3	1.5	Nylon 66	black
9	15340805	6.3 x 10	1.6	Nylon 66	black

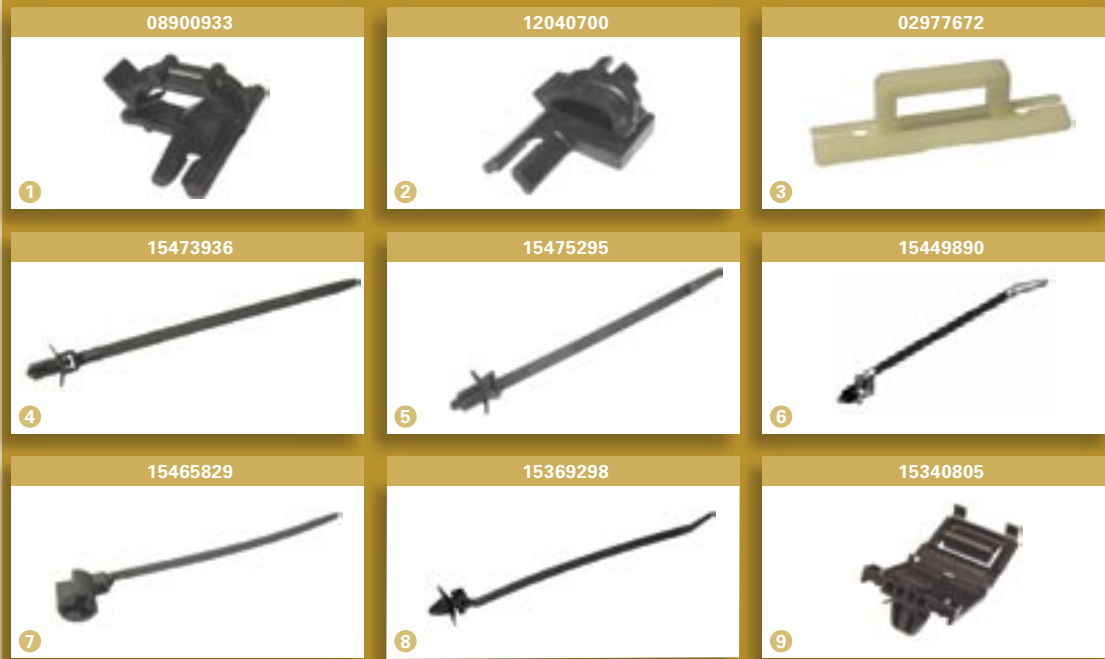

Conduit clips

Description

- Polypropylene and nylon conduit clips

Typical applications

- Used on conduit coverings for wiring harnesses

Delphi advantages

- A clip for many applications can be found

Fig	Part number	Conduit size	Hole diameter (nominal)	Sheet metal thickness (max.)	Material	Color
1	08905794	10 or 13	6.35	3.8	Polypropylene	black
2	08911294	16	6.35	3.8	Polypropylene	black
3	15336086	25	6.35	3.8	Polypropylene	natural
4	12040984	6	6.35	12.5	Polypropylene	dark gray
5	12045816	10 and 16			Polypropylene	dark gray
6	15336075	9 and 12.7 Tubing			Nylon 66	black

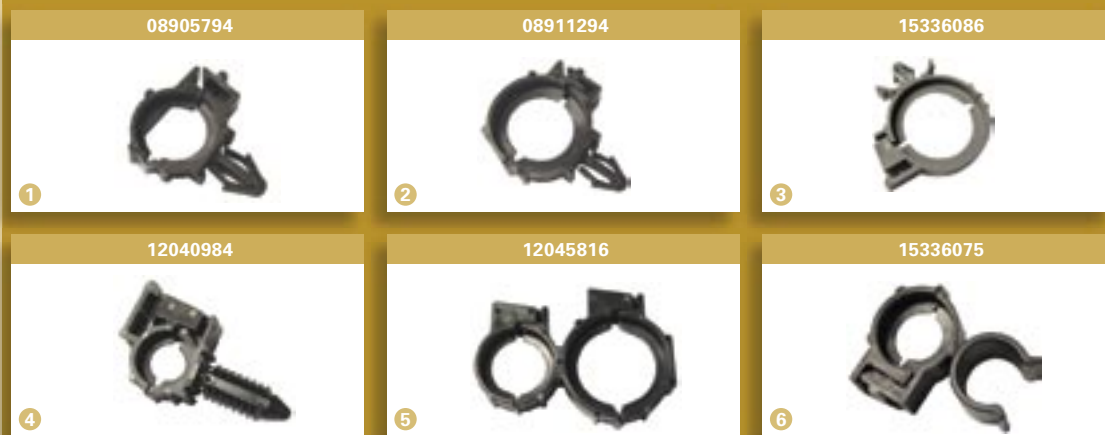

Conduit clamps and assemblies

Description

- Polypropylene and nylon conduit clips

Typical applications

- Used on conduit coverings for wiring harnesses

Delphi advantages

- A clip for many applications can be found

Fig	Part number	Conduit size	Stud/Hole size (nominal)	Mounting feature spacing	Material	Color
1	12034065	22	M6	40.5	Nylon 66/ Zinc Chromate	black
2	12052998	13	M8	16.9	Nylon 66/ Zinc Chromate	black
3	12065525	13	M10	50	Nylon 66/ Zinc Chromate	black
4	12059394	25	M10	34.6	Zinc Chromate	dark gray
5	12010824	13	M6	25.4	Phosphate Oil	
6	12020253	22	M10	41.7	Zinc Chromate	

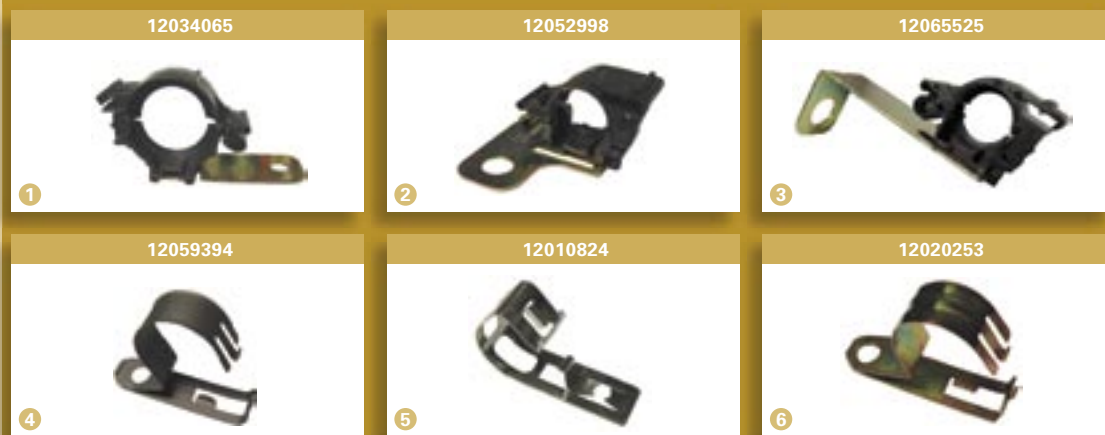

Rosebud connector fixing

Description

- Connector sheet metal fixing

Typical applications

- GT, Ducon, MP and other connector family fixings

Delphi advantages

- Fixing for all main Delphi connector families

Fig	Part number	Hole diameter (nominal)	Sheet metal thickness (max.)	Material	Color
1	15427170	8 x 15	0.8 - 2.8	PA 66	black
2	15439875	6.3	0.7 - 2.5	PA 66	black
3	10717452	6.3	1.0 - 2.1	PA 66	black
4	08905563	6.3	3.8	PP IM	black
5	12084561	6.3	3.8	PA 66 HS IM	medium grey
6	12110290	6.3	3.8	PA 66 HS IM	medium grey
7	12110517	6.35	3.8	PA 66	black
8	15358672	6.3	3.8	PP IM	black
9	15401328	8.5 x 16	0.7 - 3.0	PP HS IM	medium grey
10	12047835	6.1 - 7.0	8.0	PA 66 HS IM	black
11	12186353	max 6.63	8.0	PA 66 HS IM	black
12	15326712	max 6.35	4.0	PA 66 HS IM	black



Fir tree & connector fixing

Description

- Connector sheet metal fixing & connector carrier

Typical applications

- GT, Ducon, MP, and other connector family fixings and hang on

Delphi advantages

- Fixing for all main Delphi connector families

Fig	Part number	Hole diameter (nominal)	Sheet metal thickness (max.)	Material	Color
1	12110783	max 6.35	8.0	PA 66 HS IM	black
2	15358639	max 6.35	4.0	PA 66 HS IM	medium grey
3	15326413	max 6.35	2.0	PP IM	black
4	15336544	max 6.35	3.8	PP	black
5	12129271	max 6.25		PP mod	light grey
6	15355593	8 x 15	2.0	PA 66 HS IM	black
7	12185083	8 x 15	0.8	Nylon 6 GF15	black
8	10726669	Hang On	--	Nylon 6	black
9	10719968	Hang On	--	Nylon 6	black
10	10718048	6.3	1.5	Nylon 6	black
11	10720007	Tube Ø 15		Nylon 66	black



Automotive and Transportation Products

M/C 483.400.301
5725 Delphi Drive
Troy, Michigan 48098-2815
U.S.A.
Tel: [1] 248.813.2334
Fax: [1] 248.813.2333

Military Products

17150 Von Karman Avenue
Irvine, California 92614
U.S.A.
Tel: [1] 949.660.5701
Fax: [1] 949.660.5825

Commercial and Medical Products

19200 Asheville Highway
P.O. Box 519
Landrum, South Carolina
U.S.A.
Tel: [1] 864.457.3824
Fax: [1] 864.457.2535

Asia Pacific Regional Headquarters

31F Nomura-Buiru
1-26-2 Nishi-Shinjuku, Shinjuku
Tokyo, Japan 163-0569
Tel: [81] 3.5381.1700
Fax: [81] 3.5381.1824

European Regional Headquarters

Customer Technology Center
Vorn Eichholz 1
42119 Wuppertal
Germany
Tel: [49] 202.291.0
Fax: [49] 202.291.2777

South American Regional Headquarters

Av. Goiás, 1860
São Caetano do Sul
São Paulo 09550-050
Brazil
Tel: [55] 11.4234.9491
Fax: [55] 11.4234.9462

DELPHI

Driving Tomorrow's Technology

www.delphi.com/connect

Delphi Connection Systems reserves the right to improve, enhance and modify the design specifications and construction of Delphi products without prior notification. For additional product and engineering information, contact us at [1] 248.813.2334 or visit our website at www.delphi.com/connect