

Product Overview

Delphi's heavy duty connection systems are circular connectors designed as in-line or panel mount connections and intended for use in harsh environments such as underhood, transmission harness, etc. They can be used where there is a need for power and signal distribution utilizing a connector with small terminal centerline spacing while still being able to conduct currents up to 13 amps.

Market Segments

Automotive

Non-Automotive

Features and Benefits

- Multiple connector indexes
- Connector inserts fit both plug and receptacle shells
- Adaptable cable seal cavity flashing
- Snap in retaining ring
- Easily integrated into applications
- Same connector can be used in multiple harness designs
- Gender reversible
- Minimizes cavity plug usage
- Minimizes tooling cost
- Fully repairable connection system
- Conduit caps for flex tube available



Female Connector 31way



Male Connector 31way

Application Guidelines

- Cable Range: 0.35 - 2.00mm² (based on pin configuration)
- Current Range: up to 13 amps (based on pin configuration)
- Temperature Range: -55°C to + 125°C
- Cable Diameter: up to 4mm

Terminal Crimp Tooling

Delphi Global Crimp Tooling

PSG Hand Crimp Tool

NOTE: For correct reference of terminal part number to hand crimp tool information please contact your Power & Signal Group representative.

Connector ASM with conduit cap plus panel nut

15486583: 31 way female with panel shroud

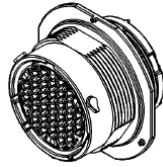

15486582: 31 way male ASM with knurled shroud

15486580: 31 way male with panel shroud



15486581: 31 way female with knurled shroud

15496832: retaining nut



15417551: 19mm conduit locking ring

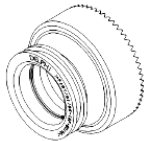

15480529: lock retainer for 19mm locking ring

15410613: 22mm conduit locking ring



15480528: lock retainer for 22mm locking ring

Connector ASM without conduit cap

15491237: 31 way male ASM



15491238: 31 way female ASM

Matching Terminals

- 15424449: female 0.35 - 0.5mm² gold plated
- 15424450: female 0.8 - 1.0mm² gold plated
- 15424512: female 2.0mm² gold plated
- 15424452: male 0.35 - 0.5mm² gold plated
- 15424453: male 0.8 - 1.0mm² gold plated
- 15424454: male 2.0mm² gold plated

For pricing and samples, contact your Power & Signal Group Representative. Or, visit us on the web at www.powerandsignal.de.

For drawings, data sheets or 3-D CAD models, call our engineering department.

REV: 24-Jan-07